



CARATTERISTICHE

1) Il kit polifunzionale che, grazie alla possibilità di sostituire il pattino superiore nel corpo carrello, consente di essere utilizzato con profili diversi, adattandosi a molteplici soluzioni

2) Semplice regolazione

3) Cuscinetto rettificato rivestito in POM 100

ISTRUZIONI PER IL MONTAGGIO

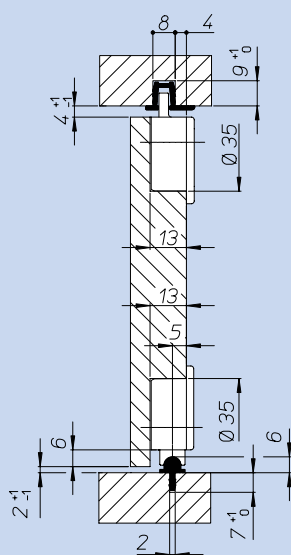

A

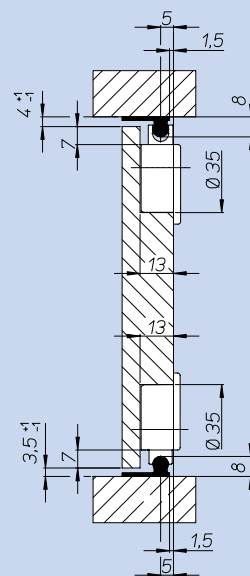

B

Kit VOLPE
CUSCINETTO GOLA
CODICE
1004503G2

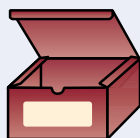

2 carrelli inferiori

2 carrelli superiori

2 fermi fine corsa

2 pattini superiori femmina

2 pattini superiori maschio

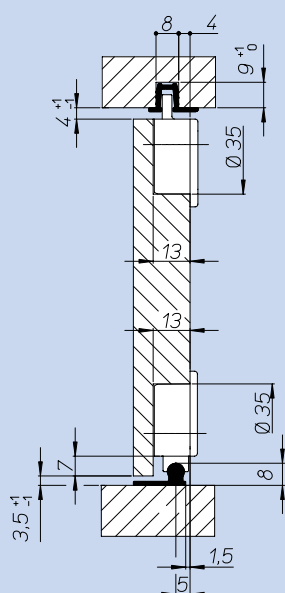

C

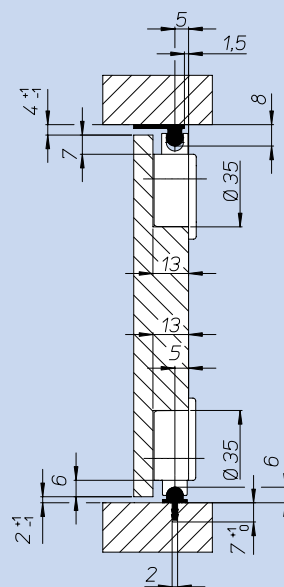

D

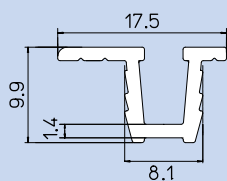

Profilo in plastica

| | |
|---------|-----------------|
| GRIGIO | CODICE 1003501G |
| BIANCO | CODICE 1003501B |
| MARRONE | CODICE 1003501M |
| NERO | CODICE 1003501N |

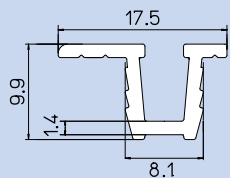
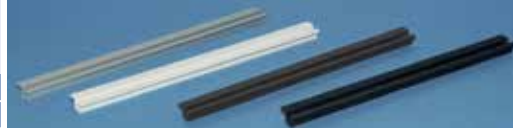

Profilo in plastica

| | |
|----------|-----------------|
| FRASSINO | CODICE 1003501F |
| CILIEGIO | CODICE 1003501C |
| DOUGLAS | CODICE 1003501D |

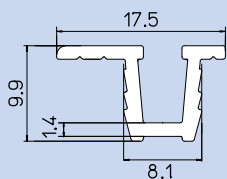

Profilo in alluminio ossidato

| | |
|---------|-----------------|
| ARGENTO | CODICE 1004501A |
| BRONZO | CODICE 1004501B |
| NERO | CODICE 1004501N |

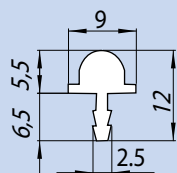
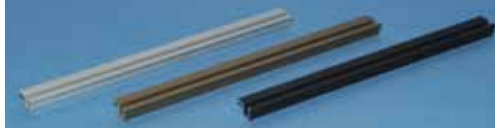

Profilo in alluminio ossidato

| | |
|---------|-----------------|
| ARGENTO | CODICE 1004001A |
| BRONZO | CODICE 1004001B |
| NERO | CODICE 1004001N |

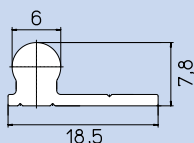

Profilo in alluminio ossidato, fori svasati ogni 30 cm, vite TSP Ø 3

| | |
|---------|-----------------|
| ARGENTO | CODICE 1004502A |
| BRONZO | CODICE 1004502B |
| NERO | CODICE 1004502N |

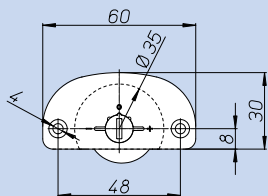

Carrello inferiore con regolazione con cuscinetto rettificato

CODICE 1004507

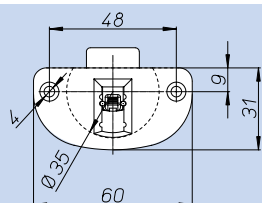

Carrello superiore con regolazione pattino maschio

CODICE 1004505

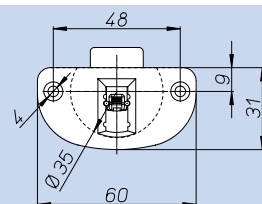

Carrello superiore con regolazione pattino femmina

CODICE 1004506

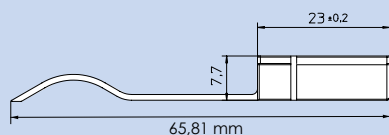

Fermo fine corsa

CODICE 1003508

